

COMPACT WHEEL DRIVE

CWD-500B

Compact Wheel Drive with Brake



Compact Design with Minimal Axial Length

Exceptional power in a compact size, offering efficiency and performance in applications where space and power are critical.

Exceptional Radial Load Capacity

Ensures robust support and stability in demanding applications, enabling the drives to handle heavy-duty tasks with ease while maintaining precision and efficiency.

Smooth Motion and High Reliability

Delivers smooth and precise motion, coupled with high reliability - ensuring minimal downtime and maintenance.

Best-in-class Power Density

Offering efficiency and performance in applications where space and power are critical.

Low Noise Operation

Enhancing the work atmosphere and complying with noise regulations.

Technical Specifications

Parameter	Units	Value
Continuous Output Torque	Nm	20
Acceleration Torque	Nm	50
Emergency Torque	Nm	75
Nominal Output Velocity	rpm	233
Maximum Output Velocity	rpm	240
Ratio		15:1
Reducer Efficiency	%	90
Noise Level @ nominal Velocity and load	dBA/1 m	<75
Backlash	Arcmin	<30
Life expectancy	Hrs.	> 30,000
Bus Voltage	VDC	48
Power	Watts	600
Wheel Diameter	Mm	160
Radial Load	N	8000
Encoder Resolution	Counts	16,384
Halls		Y
Optional Brake Torque	Nm	10
Ambient Operating Temperature	Celsius	-10 to 40
Protection Class		IP54

Dimensional Drawing:

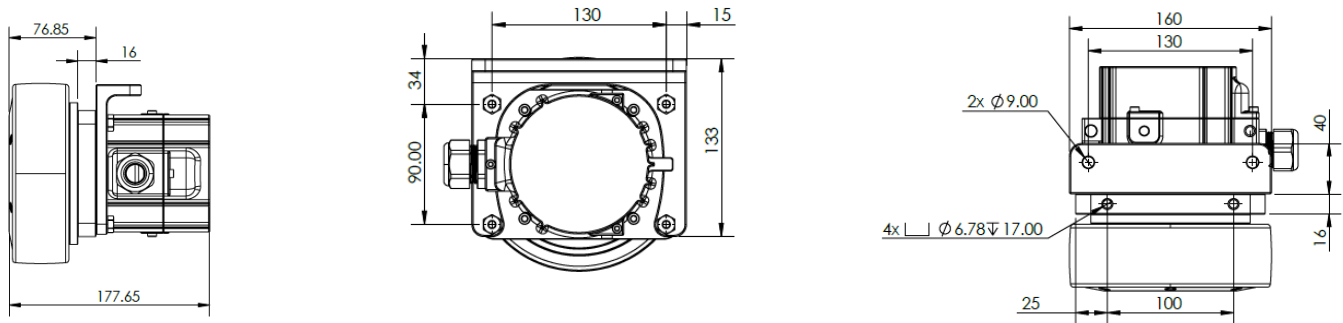

Cable and Connection:

FLYING LEADS (POWER & BRAKE)					
FUNCTION	PHASE A	PHASE B	PHASE C	BRAKE 1	BRAKE 2
COLOR	YELLOW	GREEN	BLACK	2 CONDUCTOR CABLE	

HALLS CONNECTOR: JST PHR-6 (MATES WITH XXX)						
FUNCTION	GND	+5V	HALL A	HALL C	HALL B	TEMP
PIN#	1	2	3	4	5	6

ENCODER CONNECTOR: 39-01-2160 USING 39-00-0184 CONTACTS (EXAMPLE MATE: 39-01-2161)															
FUNCTION	A+	A-	B+	B-	Z+	Z-	U+	U-	V+	V-	W+	W-	+5V	GND	SHLD
PIN#	15	8	14	16	13	6	3	9	4	10	5	11	12	7	1